

YUEQING HONGYI ELECTRONICS CO., LTD
乐清市宏一电子有限公司

SPECIFICATION FOR APPROVAL

承认书

CUSTOMER 客户名称	
DESCRIPRION 产品名称	XA 系列连接器
ITEM NO 编 号	HY-A25005 (A69-72)
DATE 日 期	2022-09-16

CUSTOMER ACKNOWLEDGEMENT SEAL

客户承认印签

(APPROVAL) 核准	(ENGINEERING) 工程	(PURCHASE) 采购	(QUALITY) 品质
承认结果: <input type="checkbox"/> 通过 <input type="checkbox"/> 不通过 <input type="checkbox"/> 重新送样			

IS09001

IS014001

IS045001

IATF16949 体系认证

ADD: No. 30, Wenjing Road, Houyu village, Shifan street, Yueqing City, Zhejiang Province

地址: 浙江省乐清市石帆街道后屿文景路 30 号

TEL:0577-62380521

FAX: 0577-62381979 P.C:325608

http: //www.zhehongyi.com

E-MAIL:yaohongxiao88@126.com

产 品 承 认 书 目 录

1、封面	1-1
2、修订履历	2-2
2、目录	3-3
3、技术规范	4-10
4、产品图纸	11-25

PRODUCT SPECIFICATION

产 品 规 范

1、Scope

适用范围

This specification includes the following specifications, including the specification of 2.50mm pitch XA series connector

本规范包括下列此种规格包括 2.50mm Pitch XA 系列连接器规格说明

2、Appearance and Dimension

外观及尺寸

2.1 Appearance:Product surface without defect、dirt、crack、and mechanical damang,Contactwithout rust,plating not oxided and not peeled.

产品表面不应有对制品有害的缺陷、污垢、裂痕及机械损伤；接触件无锈蚀、镀层氧化脱落等现象

2.2 Dimension:According to drawings

外形尺寸：依照附图

3、Disposal of Material and surface

材料与表面处理

Specification 规格内容	Material 材 质	Finish 表面处理	Environmental protection grade 环保等级	
Terminal 端 子(公、母)	Phosphor bronze 磷铜 厚 0.20mm	Tin Plating:2.5-5 μ m 镀锡：2.5-5 μ m	RoHS2.0	
Housing 胶 壳(公、母)	PA66 UL94V-0	Color: White 颜色：白色		
Wafer 针 座	Plastic 塑 壳	PA66/PA46 UL94V-0		Color:Beige 颜色：米色
	Contact 插 针	Brass 黄铜 厚Φ0.60mm		Tin Plating:2.5~5 μ m 镀锡：2.5~5 μ m
Wafer 卧贴针座	Plastic 塑 壳	PA6T UL94V-0		Color: Beige 颜色：米色
	Contact 插 针	Brass 黄铜 厚Φ0.60mm		Tin Plating:2.5~5 μ m 镀锡：2.5~5 μ m
	Solder tab 焊护耳	Brass 黄铜 卧贴厚 0.40mm		Tin Plating:2.5~5 μ m 镀锡：2.5~5 μ m
Wafer 立贴针座	Plastic 塑 壳	PA6T UL94V-0		Color: Beige 颜色：米色
	Contact 插 针	Brass 黄铜 厚Φ0.60mm		Tin Plating:2.5~5 μ m 镀锡：2.5~5 μ m
	Solder tab 焊护耳	Brass 黄铜 卧贴厚 0.40mm		Tin Plating:2.5~5 μ m 镀锡：2.5~5 μ m

4、Ratings and applicable wires

额定等级

Item 项目	Standard 规格
Rated Voltage 额定电压	250V AC/DC
Rated Current 额定电流	2A AC/DC
Ambient temperature Range 使用温度范围	-25°C - +85°C
Applicable wire insulation 适用线径	AWG22#-28#

5、Electrical Performance

电气性能

N0. 序号	Ltem 项目	Test mode 试验方法	Requirement 技术要求
5.1	ContactResistance 接触电阻	Male female cooperation, open voltage less than 20mV, current 100mA detection connector at both ends 公母配合, 开放电压20mV 以下, 电流100mA 检测连接器连接器两端	Initial: 20mΩ Max 初始: 20mΩ Max After Test: 30mΩ Max 试验后: 30mΩ Max
5.2	withstandvoltage 耐电压	Mate connectors, apply 1000V AC for 1 minute between adjacent terminal or ground 公母配合, 在相邻端子, 端子与地片之间, 使用1000V 的交流电1 分钟, 检测连接器	No Breakdown and Flashover 外观无损伤, 无打火花
5.3	InsulationResistance 绝缘电阻	Mate connectors, apply 500V DC between adjacent terminal or ground 公母配合, 在相邻端子, 端子与地片之间, 使用500V 的直流电, 检测连接器	1000MΩ Min

6、机械性能

Mechanical Performance

NO. 序号	Ltem 项目	Test mode 试验方法	Requirement 技术要求
6.1	Terminal crimping wire strength 端子压接导线强度	Fix the crimped terminal, apply axial pull out force on thewire	AWG#22 wire AWG#22 导线 40N Min
		AWG#24 wire AWG#24 导线 30N Min	
		AWG#26 wire AWG#26 导线 20N Min	
		AWG#28 wire AWG#28 导线 13N Min	
6.2	Terminal/ Housing Retention Force 端子保持力	Apply axial pull out force at the speed rate of $25.4\pm 3\text{mm}/\text{minute}$ on the terminal assembled in the Housing 以每分 $25.4\pm 3\text{mm}$ 的速率,将端子从Housing 内轴 向拔出	Per contact: 15N Min 单一接触点: 15N Min
6.3	Insertion & withdraw Force 插拔力	Insert and withdraw Connectors at the speed rate of $25.4\pm 3\text{mm}/\text{minute}$ 以每分 25.4±3mm 的速率插入和拔出	Refer to paragraph 8 参照第 8 项
6.4	Pin Retention Force Pin 针保持力	Apply axial push force at the speed rate of $25.4\pm 3\text{mm}/\text{minute}$ 以每分 $25.4\pm 3\text{mm}$ 的速率,将 PIN 针从 Wafer 内轴向拔出	Per contact: 15N Min 单一接触点: 15N Min

7、Endurance Characteristics:

环境性能

NO. 序号	Ltem 项目	Test mode 试验方法	Requirement 技术要求	
7.1	Repeated Insertion/ Withdrawal 重复插拔	When mated up to 30 cycles repeatedly by the rate of 10 cycles per minute 以每分钟不超过 10 次的速率, 将公母插拔 30 次	Contact Resistance 接触电阻	30 mΩ Max
7.2	Temperature Rise 温升测试	Mating connectors shall be energized at rating current until thermal stability is achieved, and then measured the temperature rise 公母连接器配合后, 加载额定电流直到温度上升到稳定 状态, 然后再测量温升	Temperature Rise 温升测试	30°C Max
7.3	Vibration test 振动测试	Amplitude: 1.5mm P-P Sweep time: 10~55~10 HZ in 1 minute Duration: 2 hours in each X.Y.Z axials 振幅: 1.5mm P-P 时间: 10~55~10 HZ in 1 minute 持续时间: 每轴向 2 小时	Appearance 外观	No damage 无异常
			Contact Resistance 接触电阻	30 mΩ Max
			Discontinuity 瞬断	1 micro-second Max.
7.4	Heat Resistance 耐热性	85±2°C,96 hours	Appearance 外观	No damage 无异常
			Contact Resistance 接触电阻	30 mΩ Max
7.5	Cold Resistance 耐寒性	-25±3°C,96 hours	Appearance 外观	No damage 无异常
			Contact Resistance 接触电阻	30 mΩ Max
7.6	Humidity 耐湿性	Temperature: 60±2°C Relative Humidity: 90~95% Duration: 96 hours 温度: 60±2°C 湿度: 90~95%(RH) 持续时间: 96 hours	Appearance 外观	No damage 无异常
			Contact Resistance 接触电阻	30 mΩ Max
			Withstand Voltage 耐电压	No Breakdown and Flashover 外观无损伤, 无打火花
			Insulation Resistance 绝缘电阻	1000MΩ Min

NO. 序号	Ltem 项目	Test mode 试验方法	Requirement 技术要求	
7.7	温度变化 Temperature Cycling	5 cycles of: a) -25°C 30 minutes b) +85°C 30 minutes	Appearance 外观	No damage 无异常
		从-25°C持续30 分钟升至+85°C持续30 分钟, 循环5 次	Contact Resistance 接触电阻	30 mΩ Max
7.8	Salt spray 盐雾	24±1 hours exposure to a salt spray from the 5±1% solution at 35±2°C	Appearance 外观	No damage 无异常
		在温度35±2°C, 盐水浓度5±1%下, 盐水 喷雾24±1 小时	Contact Resistance 接触电阻	30 mΩ Max
7.9	Solderability 焊锡附着性	Soldering Time: 3-5sec solder Temperature: 245±5°C 焊接时间: 3-5 秒 焊接温度: 245±5°C	Solder Wetting 焊料润湿	Immersion area above 95% 浸渍面积 95% 以上
7.10	Solder- Resistance 焊锡耐热性	<p>DIP type PA66 material welding heat resistance range: Soldering time:3~5sec solder. Temperature:230±5°C DIP 型 PA66 材质焊接耐热范围: 焊接时间: 3~5 秒. 焊接温度: 230±5°C</p> <p>DIP type PA46 material welding heat resistance range: Soldering time:3~5sec solder. Temperature:245±5°C DIP 型 PA46 材质焊接耐热范围: 焊接时间: 3~5 秒. 焊接温度: 245±5°C</p> <p>SMT reflow soldering heat resistance range: Soldering time:5~10sec solder. Temperature:255±5°C SMT 型回流焊接耐热范围: 焊接时间: 5~10 秒. 焊接温度: 255±5°C</p> <p>Please refer to the 9.1 solder reflow temperature curve 回流焊请参考 9.1 温度曲线图</p>	Appearance 外观	No damage 无异常

8、INSERTION/WITHDRAWAL FORCE

综合插入力及拔出力

8.1、Single row comprehensive insertion and extraction force

单排综合插入力及拔出力

No. of CTK PIN 数	At Initial 初始值		At 30th 插拔 30 次	No. of CTK PIN 数	At Initial 初始值		At 30th 插拔 30 次
	I. F (N Max) 插入力	W. F (N Min) 拔出力	W. F (N Min) 拔出力		I. F (N Max) 插入力	W. F (N Min) 拔出力	W. F (N Min) 拔出力
2	20	1.0	0.8	12	70	6.0	5.0
3	25	1.5	1.0	13	75	6.5	5.5
4	30	2.0	1.2	14	80	7.0	6.0
5	35	2.5	1.5	15	85	7.5	6.5
6	40	3.0	2.0	16	90	8.0	7.0
7	45	3.5	2.5	17	95	8.5	7.5
8	50	4.0	3.0	18	100	9.0	8.0
9	55	4.5	3.5	19	105	9.5	8.5
10	60	5.0	4.0	20	110	10	9.0
11	65	5.5	4.5				

8.2、Dual row comprehensive insertion and extraction forces

双排综合插入力及拔出力

No. of CTK PIN 数	At Initial 初始值		At 30th 插拔 30 次	No. of CTK PIN 数	At Initial 初始值		At 30th 插拔 30 次
	I. F (N Max) 插入力	W. F (N Min) 拔出力	W. F (N Min) 拔出力		I. F (N Max) 插入力	W. F (N Min) 拔出力	W. F (N Min) 拔出力
2*2	35	10	8	2*12	115	26	24
2*3	45	12	10	2*13	120	27	25
2*4	55	14	12	2*14	125	28	26
2*5	65	16	14	2*15	130	29	27
2*6	75	18	16	2*16	135	30	28
2*7	80	20	18	2*17	140	31	29
2*8	85	22	20	2*18	145	32	30
2*9	90	23	21	2*19	150	33	31
2*10	100	24	22	2*20	155	34	32
2*11	110	25	23				

9、 SMT lead-free process temperature curve SMT 无铅工艺温度曲线

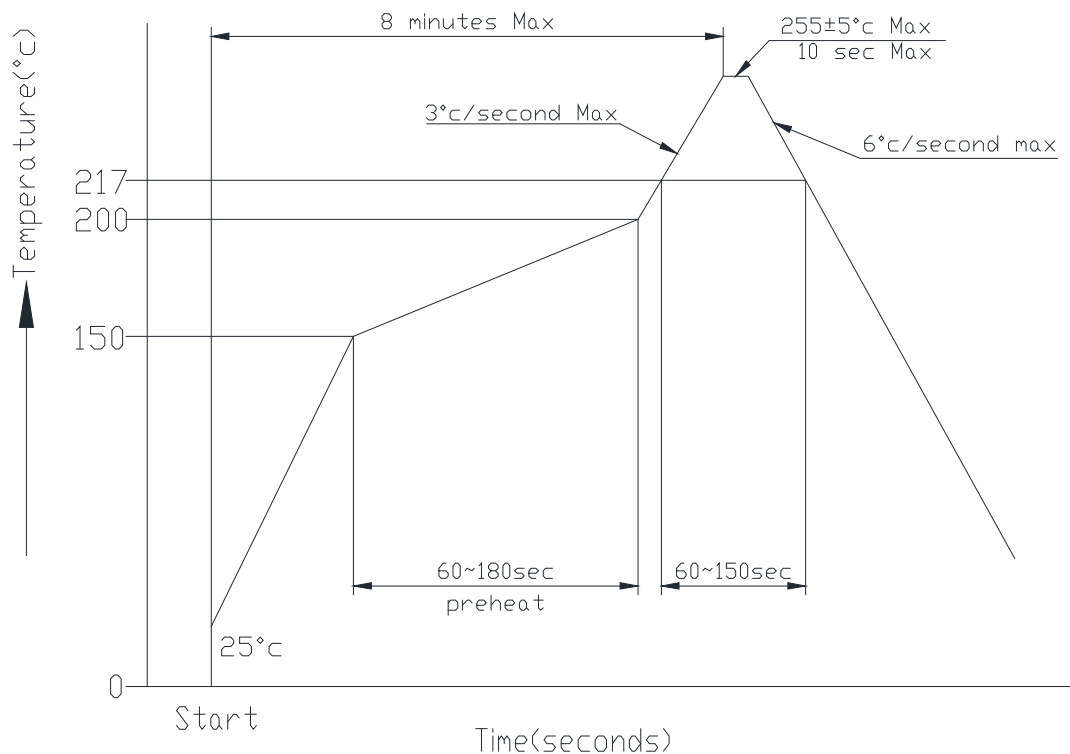

Notes: Please check the reflow soldering condition by your own devices beforehand. Because the condition changes by the soldering devices, P.C. boards, and so on

注记: 由于 P.C 板等焊接装置改变条件,所以请预先用自己的装置检查回流焊的条件

10、 Caution 注意事项

plastic because of characteristics with water after package is opened should avoid exposure to, the temperature is higher than 30 °C, humidity is higher than 60%RH in the environment, and in the 24 hours after all after use, to prevent subsequent reflow, wave soldering process to produce foaming phenomenon of deformation

塑料因具有吸水之特性包装拆封后应避免暴露于, 温度高于 30°C, 湿度高于 60%RH 的环境中, 并在拆封后 24 小时内全数使用完毕, 防止后续回流焊、波峰焊制程产生起泡变形现象

版本 REV.	日期 DATE	ECN NO.	变更内容 DESCRIPTION	制图 DRAWN

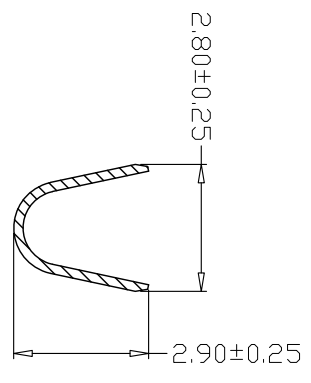
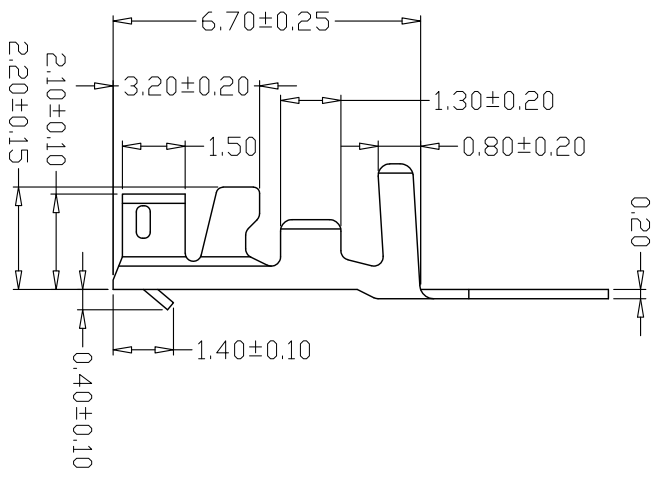
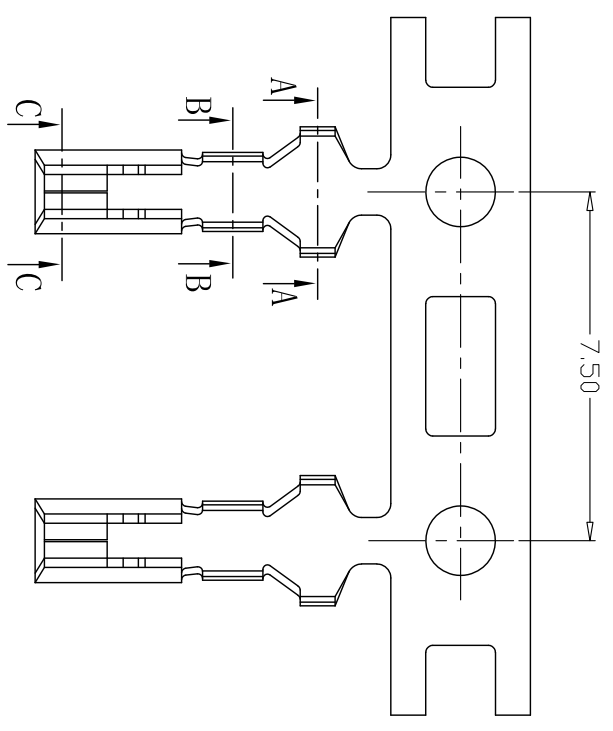

SEC:A-A

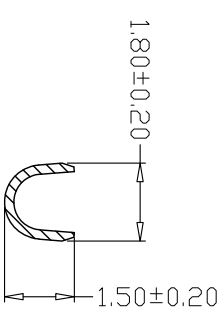

SEC:B-B

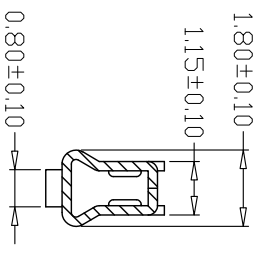

SEC:C-C

SPECIFICATIONS

- 1、Current Rating: 3A AC, DC
- 2、Voltage Rating: 250V AC, DC
- 3、Temperature Range: -25°C~+85°C
- 4、Contact Resistance: 20mΩ Max
- 5、Insulation Resistance: 1000MΩ Min
- 6、Withstanding Voltage: 1000V AC/minute
- 7、Material: Phosphoric bronze Tin-plated
- 8、Applicable Wire Sizes: AWG#22~28#

GENERAL TOLERANCE		制图 Mapping		张迎春		料号 PART NO.	A25005-T	版本 REV.	A
X ^o ±0.25	X ^o ±2°	审核 Audit	钱岳生	2022. 09、 15		品名 TITLE	XA端子	页次 SHEET	1/1
X±0.25	X ^o ±1°	核准 Approved	张名	2022. 09、 16		客户料号 CSTM. NO.			
.XX±0.15	.XX ^o ±0.5°	单位 Units	mm	比例 SCALE					
.XXX±0.10	.XXX ^o ±0.5°							乐清市宏一电子有限公司 Yueqing Hongyi Electronics Co., Ltd	

版本 REV.	日期 DATE	ECN NO.	变更内容 DESCRIPTION	制图 DRAWN

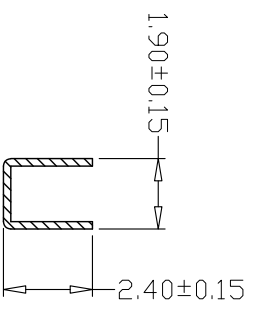
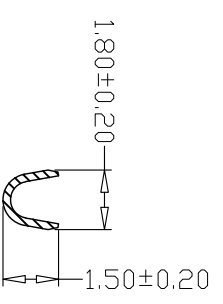
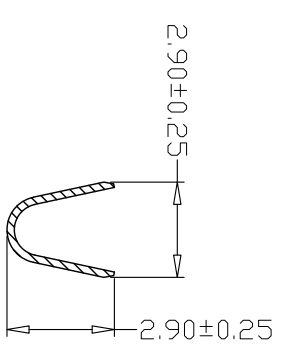
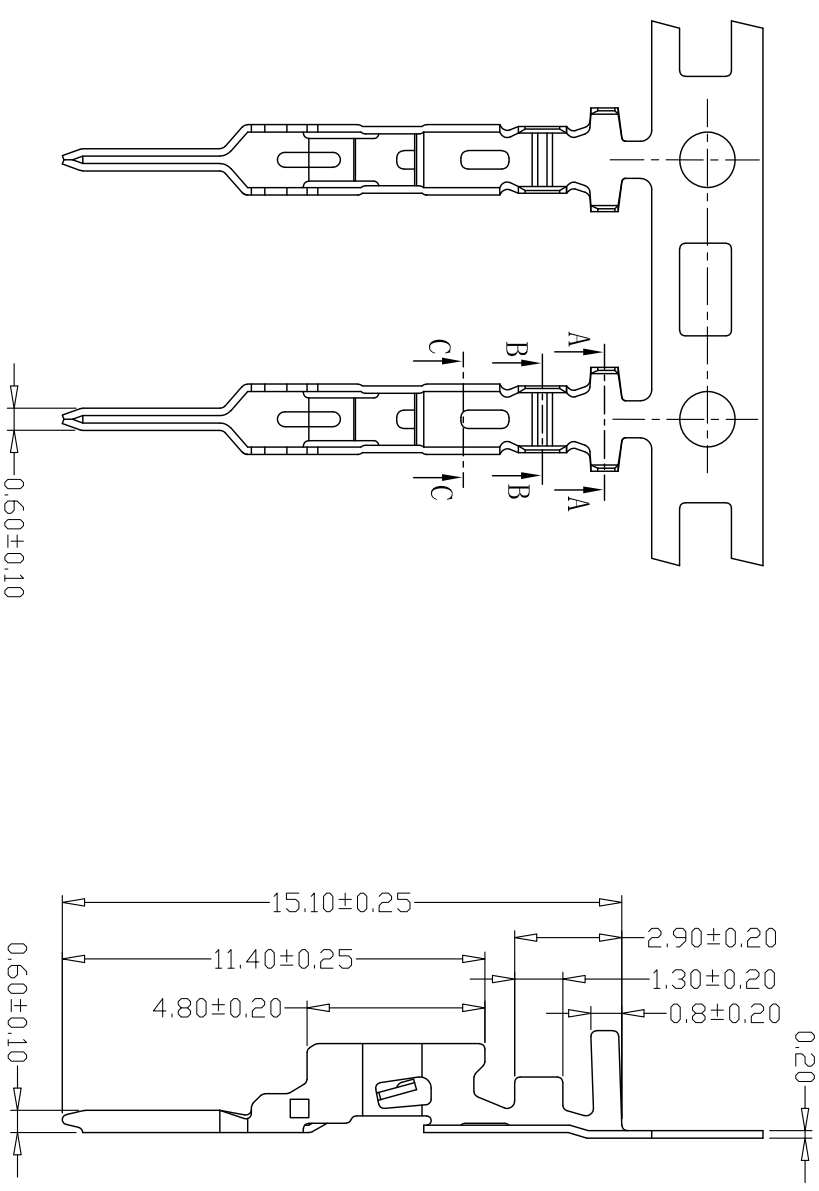

SPECIFICATIONS

- 1、Current Rating: 3A AC, DC
- 2、Voltage Rating: 250V AC, DC
- 3、Temperature Range: -25°C~+85°C
- 4、Contact Resistance: 20mΩ Max
- 5、Insulation Resistance: 1000MΩ Min
- 6、Withstanding Voltage: 1500V AC/minute
- 7、Material: Phosphoric bronze Tin-plated
- 8、Applicable Wire Sizes: AWG#22~28#

GENERAL TOLERANCE		制图 Mapping		张迎春		料号 PART NO.		版本 REV.	
X ₁ ±0.25	X°±2°	审核 Audit		2022. 09、 15		A25005-RT		A	
X ₂ ±0.25	X°±1°	核准 Approved		张名		品名 TITLE		页次 SHEET	
.XX±0.15	.XX°±0.5°	单位 Units		2022. 09、 16		XA空中对接公端		1/1	
.XXX±0.10	.XXX°±0.5°	比例 SCALE		7		客户料号 CUST. NO.			

乐清市宏一电子有限公司
Yueqing Hongyi Electronics Co., Ltd

版本 REV.	日期 DATE	ECN NO.	变更内容 DESCRIPTION	制图 DRAWN

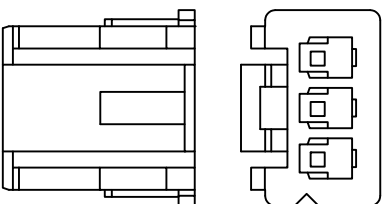
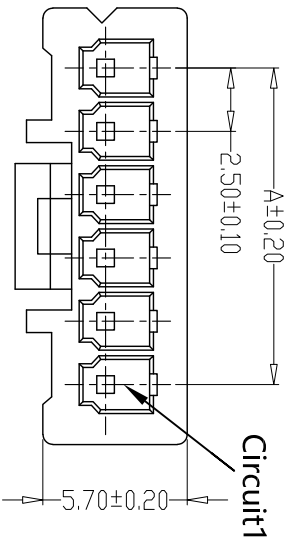

2-3Y

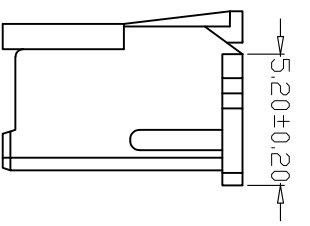
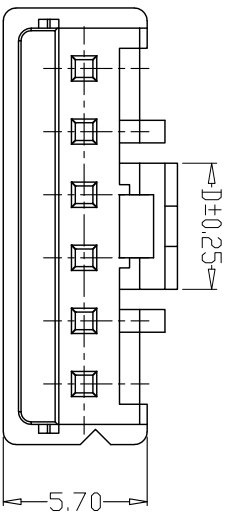
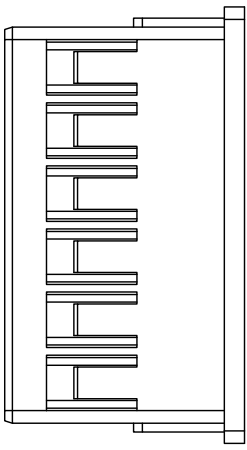
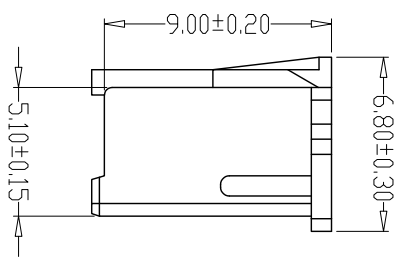
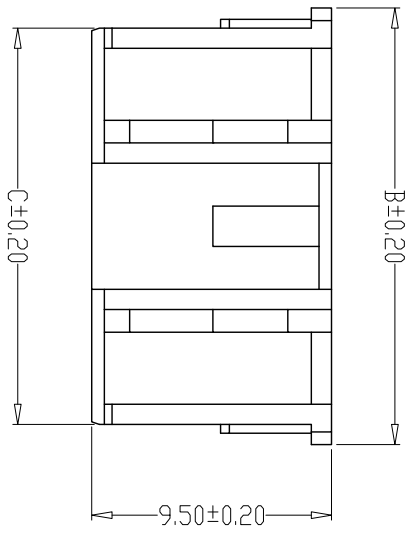

2Y

SPECIFICATIONS

- 1、Current Rating: 3A AC, DC
- 2、Voltage Rating: 250V AC, DC
- 3、Temperature Range: -25°C~+85°C
- 4、Contact Resistance: 20mΩ Max
- 5、Insulation Resistance: 1000MΩ Min
- 6、Withstanding Voltage: 1000V AC/minute
- 7、Material: PA66, UL94V-0

PIN	尺寸 (mm)			
	A	B	C	D
-02Y	2.50	7.20	5.70	3.00
-03Y	5.00	9.70	8.20	4.40
-04Y	7.50	12.20	10.70	4.80
-05Y	10.00	14.70	13.20	4.80
-06Y	12.50	17.20	15.70	4.80
-07Y	15.00	19.70	18.20	4.80
-08Y	17.50	22.20	20.70	4.80
-09Y	20.00	24.70	23.20	4.80
-10Y	22.50	27.20	25.70	4.80
-11Y	25.00	29.70	28.20	4.80
-12Y	27.50	32.20	30.70	4.80
-13Y	30.00	34.70	33.20	4.80
-14Y	32.50	37.20	35.70	4.80
-15Y	35.00	39.70	38.20	4.80
-16Y	37.50	42.20	40.70	4.80
-17Y	40.00	44.70	43.20	4.80
-18Y	42.50	47.20	45.70	4.80
-19Y	45.00	49.70	48.20	4.80
-20Y	47.50	52.20	50.70	4.80

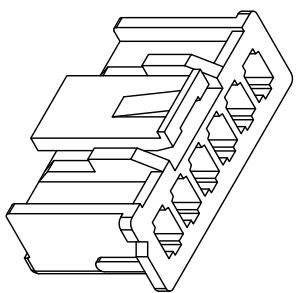

GENERAL TOLERANCE		制图 Mapping		张迎春	
X ₁ ±0.25	X ₂ ±2°	审核	2022.09.15	钱岳生	2022.09.15
X ₃ ±0.25	X ₄ ±1°	批准	2022.09.16	张名	2022.09.16
X ₅ ±0.15	X ₆ ±0.5°	单位	mm	比例	SCALE
.XXX±0.10	.XXX±0.5°	Units			

料号 PART NO.	A25005-nY	版本 REV.	A
品名 TITLE	XA孔座	页次 SHEET	1/1
客户料号 CUST. NO.			
乐清市宏一电子有限公司 YueDing HongYi Electronics Co., Ltd			

REV.	日期	ECN NO.	变更内容	制图
DATE	DATE	DESCRIPTION	DRAWN	

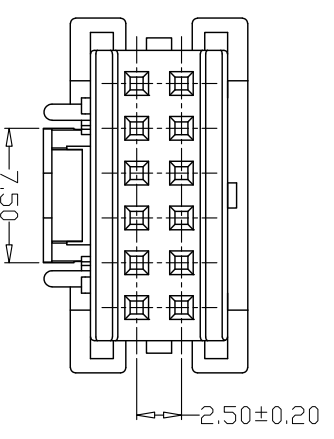
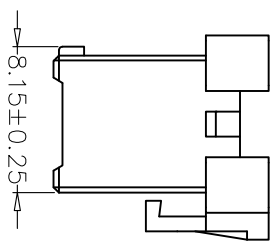
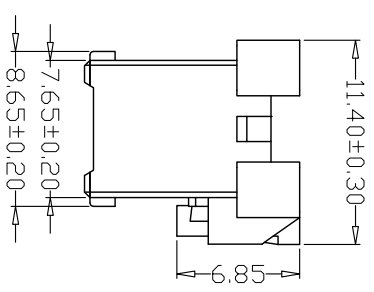
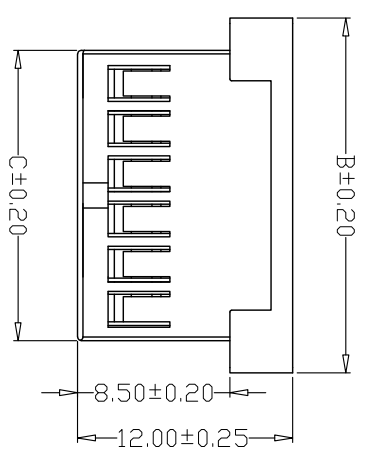
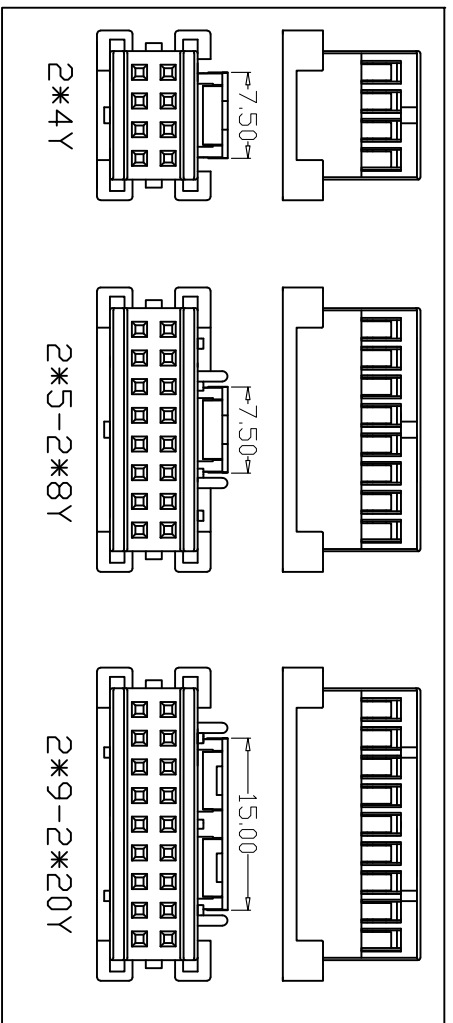
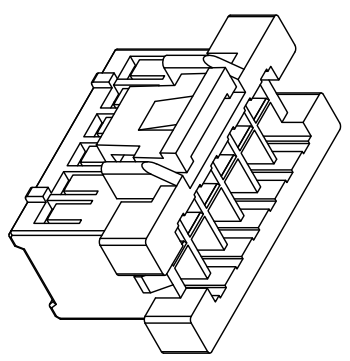
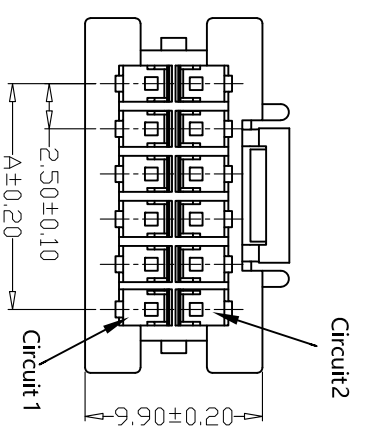

SPECIFICATIONS

- 1、Current Rating: 3A AC, DC
- 2、Voltage Rating: 250V AC, DC
- 3、Temperature Range: -25°C~+85°C
- 4、Contact Resistance: 20mΩ Max
- 5、Insulation Resistance: 1000MΩ Min
- 6、Withstanding Voltage: 1000V AC/minute
- 7、Material: PA66, UL94V-0

PIN	尺寸 (mm)		
	A	B	C
-2*04Y	7.50	15.00	11.20
-2*05Y	10.00	17.50	13.70
-2*06Y	12.50	20.00	16.20
-2*07Y	15.00	22.50	18.70
-2*08Y	17.50	25.00	21.20
-2*09Y	20.00	27.50	23.70
-2*10Y	22.50	30.00	26.20
-2*11Y	25.00	32.50	28.70
-2*12Y	27.50	35.00	31.20
-2*13Y	30.00	37.50	33.70
-2*14Y	32.50	40.00	36.20
-2*15Y	35.00	42.50	38.70
-2*16Y	37.50	45.00	41.20
-2*17Y	40.00	47.50	43.70
-2*18Y	42.50	50.00	46.20
-2*19Y	45.00	52.50	48.70
-2*20Y	47.50	55.00	51.20

GENERAL TOLERANCE		制图		料号	
X±0.25	X°±2°	Mapping	张迎春	A25005-2*nY	版本
X±0.25	X°±1°	审核	钱岳生	XA双排孔座	REV.
.XX±0.15	.XX°±0.5°	核准	张名		A
.XXX±0.10	.XXX°±0.5°	单位	2022.09.16		
		Units	mm	比例	
			SCALE		

乐清市宏一电子有限公司
YueDing HongYi Electronics Co., Ltd

版本 REV.	日期 DATE	ECN NO.	变更内容 DESCRIPTION	制图 DRAWN

SPECIFICATIONS

- 1、Current Rating: 3A AC, DC
- 2、Voltage Rating: 250V AC, DC
- 3、Temperature Range: -25°C~+85°C
- 4、Contact Resistance: 20mΩ Max
- 5、Insulation Resistance: 1000MΩ Min
- 6、Withstanding Voltage: 1000V AC/minute
- 7、Material: PA66, UL94V-0

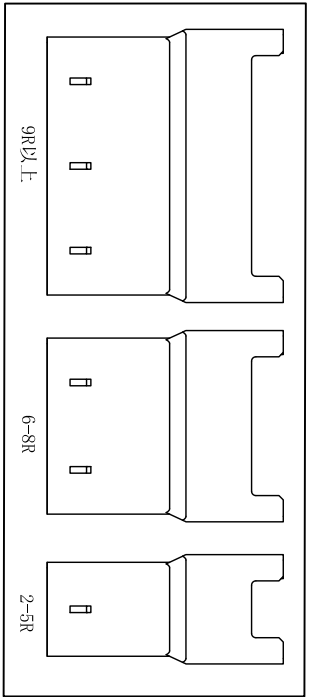
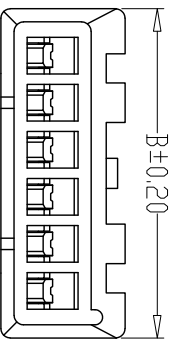

卡点结构示意图

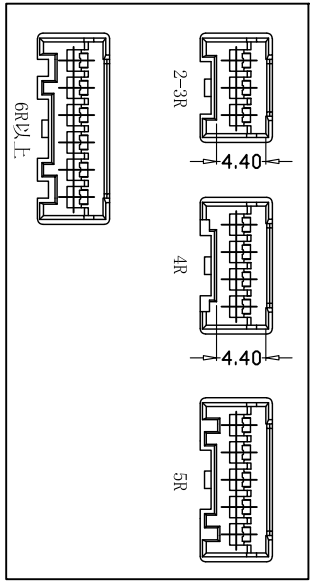
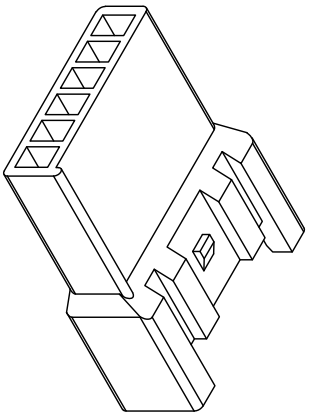
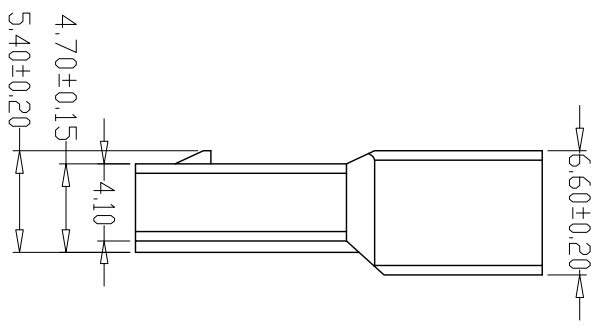
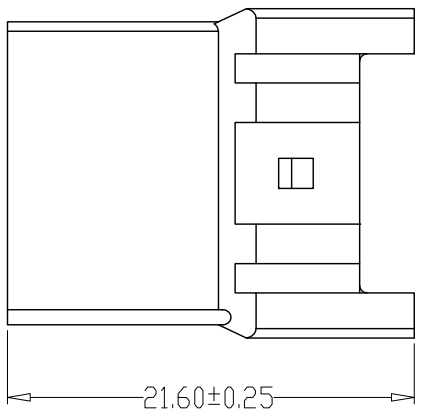

卡槽结构示意图

PIN	尺寸 (mm)			
	A	B	C	D
-02R	2.50	7.50	6.10	6.00
-03R	5.00	10.00	8.60	8.50
-04R	7.50	12.50	11.10	11.00
-05R	10.00	15.00	13.60	13.50
-06R	12.50	17.50	16.10	16.00
-07R	15.00	20.00	18.60	18.50
-08R	17.50	22.50	21.10	21.00
-09R	20.00	25.00	23.60	23.50
-10R	22.50	27.50	26.10	26.00
-11R	25.00	30.00	28.60	28.50
-12R	27.50	32.50	31.10	31.00
-13R	30.00	35.00	33.60	33.50
-14R	32.50	37.50	36.10	36.00
-15R	35.00	40.00	38.60	38.50

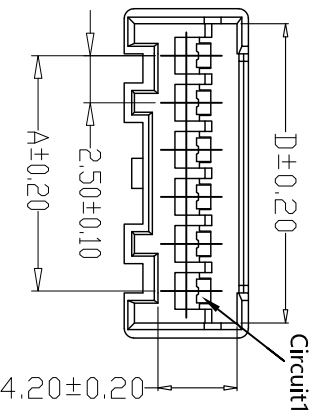

GENERAL TOLERANCE		制图 Mapping		张迎春	
X _{±0.25}	X _{±2°}	审核	钱岳生	日期	2022.09.15
X _{±0.25}	X _{±1°}	批准	张名	日期	2022.09.15
.XX _{±0.15}	.XX _{±0.5°}	Approved	2022.09.16	比例	SCALE
.XXX _{±0.10}	.XXX _{±0.5°}	Units	mm	比例	SCALE

料号 PART NO. A25005-nR

品名 TITLE XA空中对接母壳

客户料号 CSTM. NO.

版本 REV. A

页次 SHEET 1/1

乐清市宏一电子有限公司 YueDing HongYi Electronics Co., Ltd

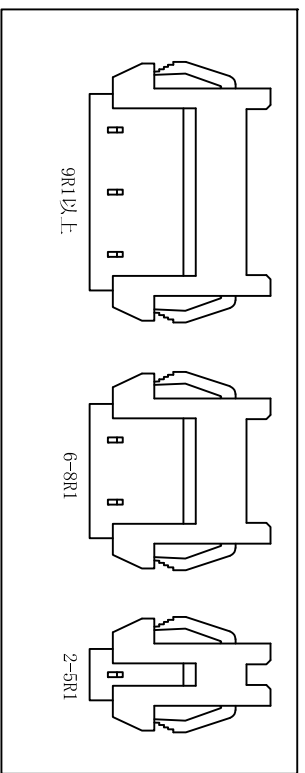
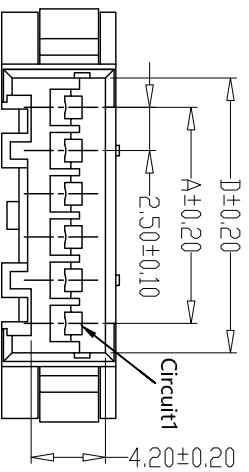

卡点结构示意图

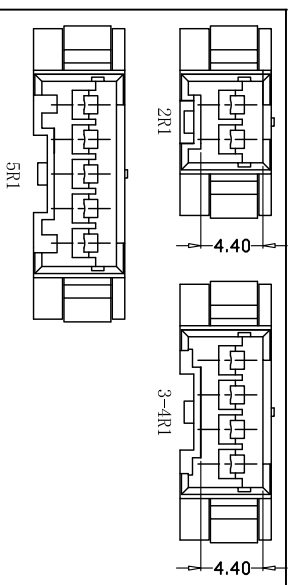

卡槽结构示意图

- SPECIFICATIONS
- 1、Current Rating: 3A AC, DC
 - 2、Voltage Rating: 250V AC, DC
 - 3、Temperature Range: -25°C~+85°C
 - 4、Contact Resistance: 20mΩ Max
 - 5、Insulation Resistance: 1000MΩ Min
 - 6、Withstanding Voltage: 1000V AC/minute
 - 7、Material: PA66, UL94V-0

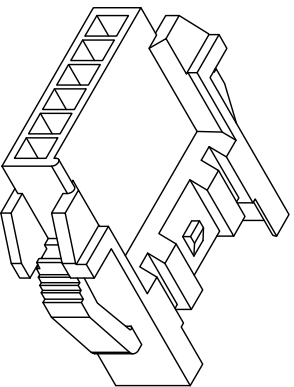
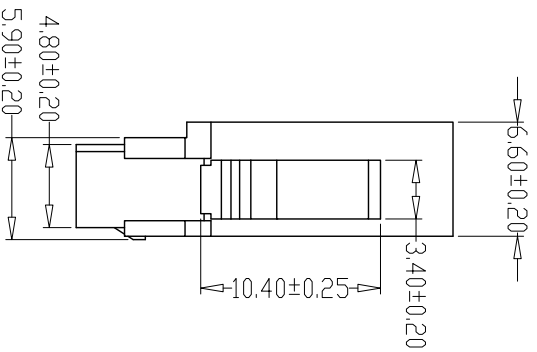
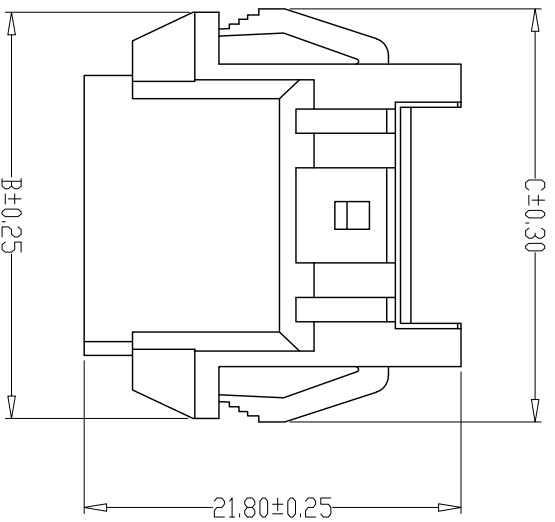

PIN	尺寸 (mm)			
	A	B	C	D
-02R1	2.50	13.40	14.00	6.00
-03R1	5.00	15.90	16.50	8.50
-04R1	7.50	18.40	19.00	11.00
-05R1	10.00	20.90	21.50	13.50
-06R1	12.50	23.40	24.00	16.00
-07R1	15.00	25.90	26.50	18.50
-08R1	17.50	28.40	29.00	21.00
-09R1	20.00	30.90	31.50	23.50
-10R1	22.50	33.40	34.00	26.00
-11R1	25.00	35.90	36.50	28.50
-12R1	27.50	38.40	39.00	31.00
-13R1	30.00	40.90	41.50	33.50
-14R1	32.50	43.40	44.00	36.00
-15R1	35.00	45.90	46.50	38.50

GENERAL TOLERANCE		制图 Mapping		料号 PART NO.		版本 REV.	
X _{±0.25}	X°±2°	审核	张迎春	A25005-1R1	版本	A	
X _{±0.25}	X°±1°	批准	钱岳生		页次	1/1	
.XX±0.15	.XX°±0.5°	Approved	2022.09.15		客户料号		
.XXX±0.10	.XXX°±0.5°	Units	2022.09.16		CITL NO.		
		mm	SCALE				

乐清市宏一电子有限公司
YueQing HongYi Electronics Co., Ltd

版本 REV.	日期 DATE	ECN NO.	变更内容 DESCRIPTION	制图 DRAWN
------------	------------	---------	---------------------	-------------

- SPECIFICATIONS**
- 1、Current Rating: 3A AC, DC
 - 2、Voltage Rating: 250V AC, DC
 - 3、Temperature Range: -25°C~+85°C
 - 4、Contact Resistance: 20mΩ Max
 - 5、Insulation Resistance: 1000MΩ Min
 - 6、Withstanding Voltage: 1000V AC/minute
 - 7、Material: Wafer PA66, UL94V-0
PIN Brass Tin-plated

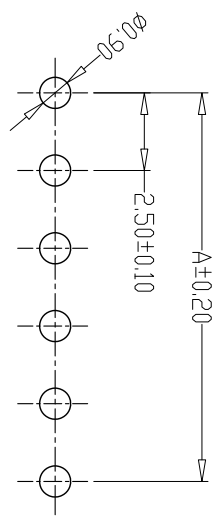
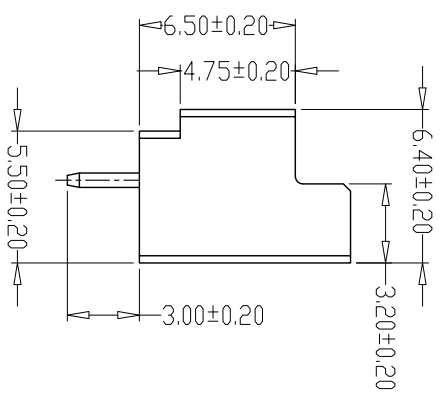
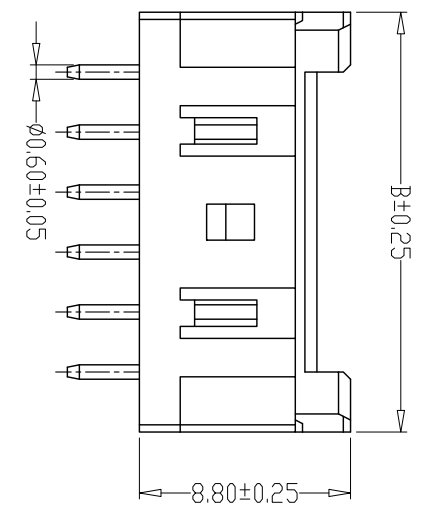
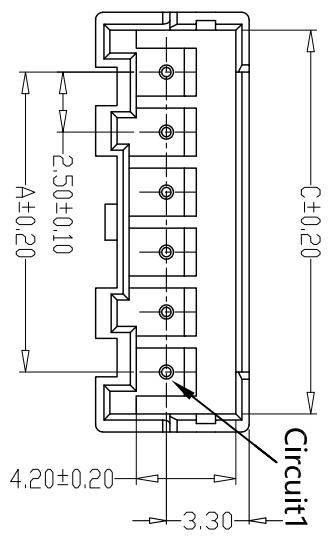

PCB LAYOUT

PIN	尺寸 (mm)		
	A	B	C
-02A	2.50	7.50	6.00
-03A	5.00	10.00	8.50
-04A	7.50	12.50	11.00
-05A	10.00	15.00	13.50
-06A	12.50	17.50	16.00
-07A	15.00	20.00	18.50
-08A	17.50	22.50	21.00
-09A	20.00	25.00	23.50
-10A	22.50	27.50	26.00
-11A	25.00	30.00	28.50
-12A	27.50	32.50	31.00
-13A	30.00	35.00	33.50
-14A	32.50	37.50	36.00
-15A	35.00	40.00	38.50
-16A	37.50	42.50	41.00
-17A	40.00	45.00	43.50
-18A	42.50	47.50	46.00
-19A	45.00	50.00	48.50
-20A	47.50	52.50	51.00

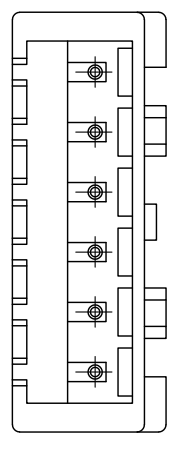
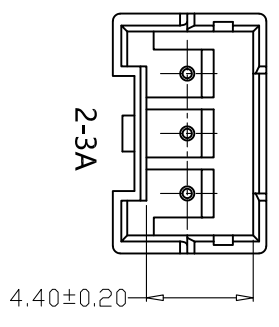
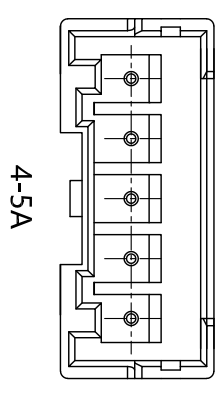

GENERAL TOLERANCE		制图 Mapping		张迎春	
X \pm 0.25	X \pm 2°	审核 Audit	钱岳生	2022.09.15	
X \pm 0.25	X \pm 1°	批准 Approved	张名	2022.09.16	
.XX \pm 0.15	.XX \pm 0.5°	单位 Units	mm	比例 SCALE	
.XXX \pm 0.10	.XXX \pm 0.5°				
料号 PART NO.		品名 TITLE		版本 REV.	
A25005-nA		XA直针 WAFER DIP TYPE		A	
客户料号 CUST. NO.		页次 SHEET		1/1	

乐清市宏一电子有限公司
YueQing HongYi Electronics Co., Ltd

版本 REV.	日期 DATE	ECN NO.	变更内容 DESCRIPTION	制图 DRAWN

- SPECIFICATIONS**
- 1、Current Rating: 3A AC, DC
 - 2、Voltage Rating: 250V AC, DC
 - 3、Temperature Range: -25°C~+85°C
 - 4、Contact Resistance: 20mΩ Max
 - 5、Insulation Resistance: 1000MΩ Min
 - 6、Withstanding Voltage: 1000V AC/minute
 - 7、Material: Wafer PA66, UL94V-0
PIN Brass Tin-plated

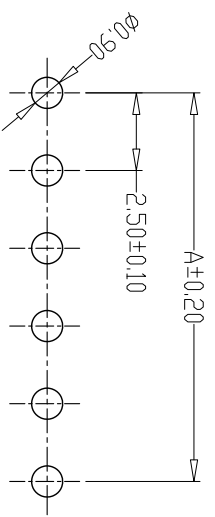
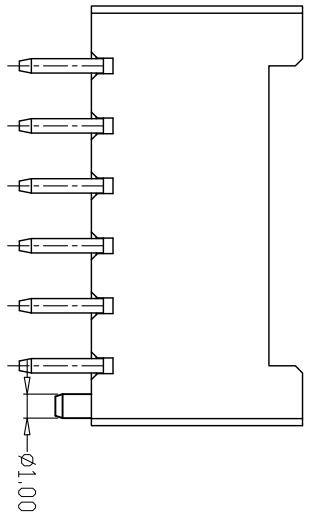
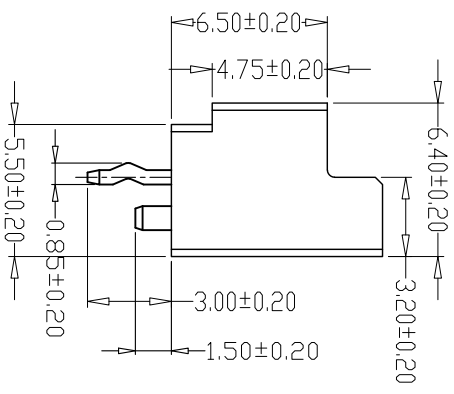
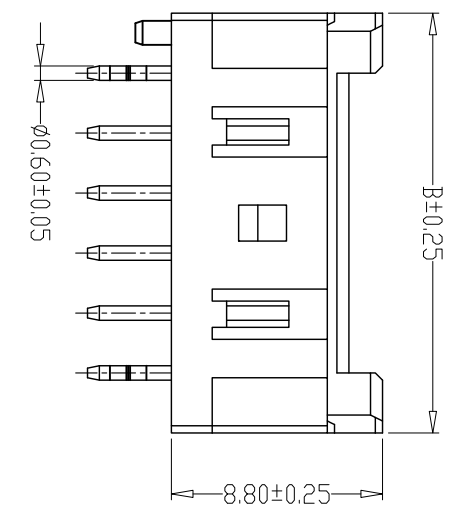
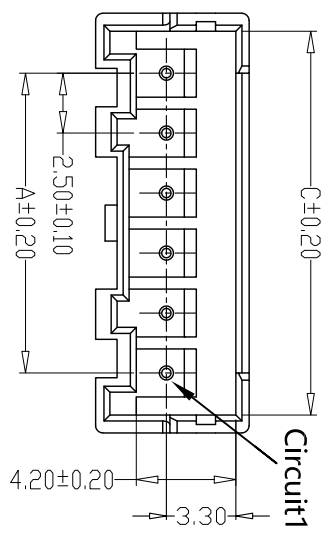

PCB LAYOUT

PIN	尺寸 (mm)		
	A	B	C
-02A1	2.50	7.50	6.00
-03A1	5.00	10.00	8.50
-04A1	7.50	12.50	11.00
-05A1	10.00	15.00	13.50
-06A1	12.50	17.50	16.00
-07A1	15.00	20.00	18.50
-08A1	17.50	22.50	21.00
-09A1	20.00	25.00	23.50
-10A1	22.50	27.50	26.00
-11A1	25.00	30.00	28.50
-12A1	27.50	32.50	31.00
-13A1	30.00	35.00	33.50
-14A1	32.50	37.50	36.00
-15A1	35.00	40.00	38.50
-16A1	37.50	42.50	41.00
-17A1	40.00	45.00	43.50
-18A1	42.50	47.50	46.00
-19A1	45.00	50.00	48.50
-20A1	47.50	52.50	51.00

4-5A1

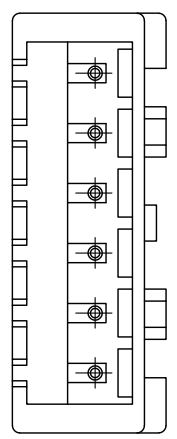
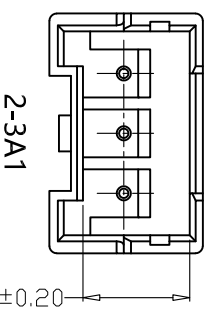
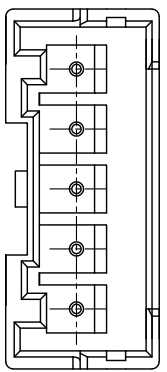

GENERAL TOLERANCE		制图 Mapping	张迎春
X \pm 0.25	X \pm 2°	审核 Audit	钱岳生
X \pm 0.25	X \pm 1°	批准 Approved	张名
.XX \pm 0.15	.XX \pm 0.5°	单位 Units	2022.09.16
.XXX \pm 0.10	.XXX \pm 0.5°	比例 SCALE	

料号: A25005-mA1
 品名: XA直针带柱
 WAFER DIP TYPE
 客户料号: CIRM. NO.
 版本: 1
 页次: 1/1
 比例: 1:1

乐清市宏一电子有限公司
 YueDing HongYi Electronics Co., Ltd

版本 REV.	日期 DATE	ECN NO.	变更内容 DESCRIPTION	制图 DRAWN
			-	

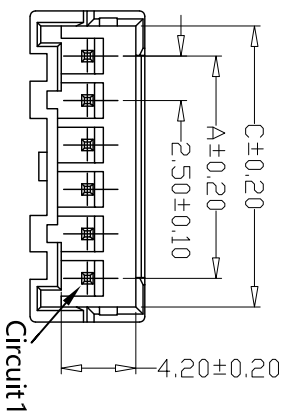

- SPECIFICATIONS**
- 1、Current Rating: 3A AC, DC
 - 2、Voltage Rating: 250V AC, DC
 - 3、Temperature Range: -25°C~+85°C
 - 4、Contact Resistance: 20mΩ Max
 - 5、Insulation Resistance: 1000MΩ Min
 - 6、Withstanding Voltage: 1000V AC/minute
 - 7、Material: Wafer PA66, UL94V-0
PIN Brass Tin-plated

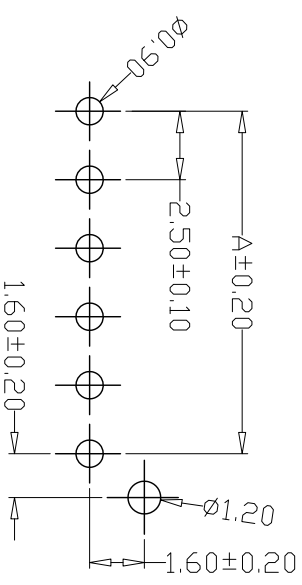
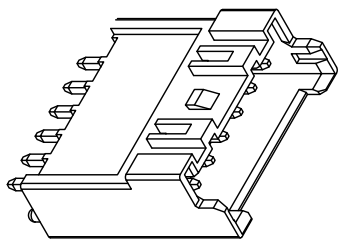

PCB LAYOUT

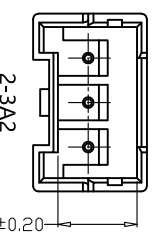
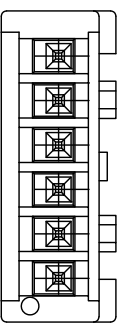
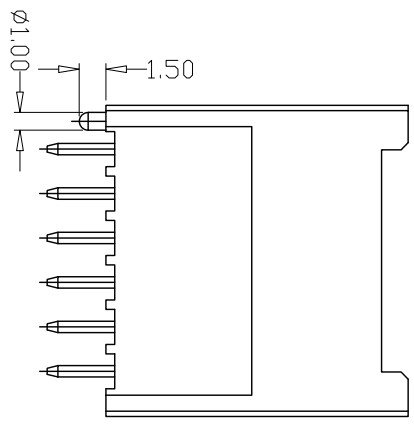
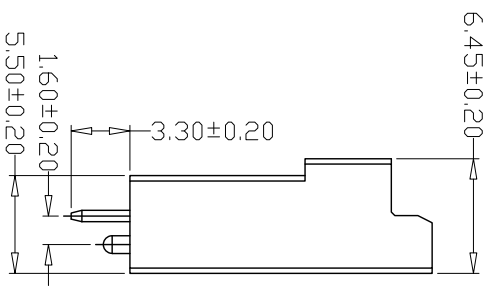
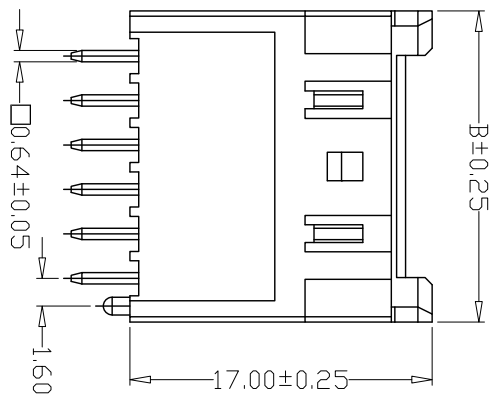

4-5A2

PIN	尺寸 (mm)		
	A	B	C
-02A2	2.50	7.50	6.00
-03A2	5.00	10.00	8.50
-04A2	7.50	12.50	11.00
-05A2	10.00	15.00	13.50
-06A2	12.50	17.50	16.00
-07A2	15.00	20.00	18.50
-08A2	17.50	22.50	21.00
-09A2	20.00	25.00	23.50
-10A2	22.50	27.50	26.00
-11A2	25.00	30.00	28.50
-12A2	27.50	32.50	31.00
-13A2	30.00	35.00	33.50
-14A2	32.50	37.50	36.00
-15A2	35.00	40.00	38.50

GENERAL TOLERANCE		制图 Mapping	张迎春
X _{±0.25}	X _{±2°}	审核 Audit	钱岳生
X _{±0.25}	X _{±1°}	批准 Approved	张名
.XX _{±0.15}	.XX _{±0.5°}	单位 Units	2022. 09. 16
.XXX _{±0.10}	.XXX _{±0.5°}	mm	比例 SCALE

料号 PART NO.	A25005-TA2	版本 REV.	A
品名 TITLE	XAC (XA加高) 直针	页次 SHEET	1/1
客户料号 WAFER DIP TYPE			
CITL. NO.		乐清市宏一电子有限公司 YueDing HongYi Electronics Co., Ltd	

版本 REV.	日期 DATE	变更内容 DESCRIPTION	制图 DRAWN
ECN NO.			

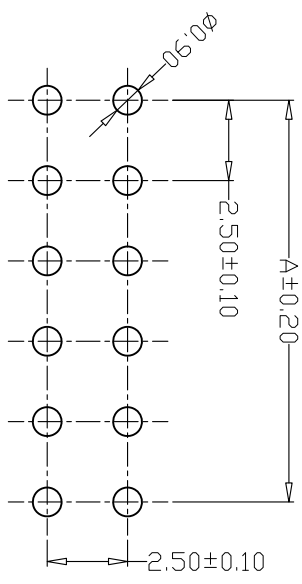
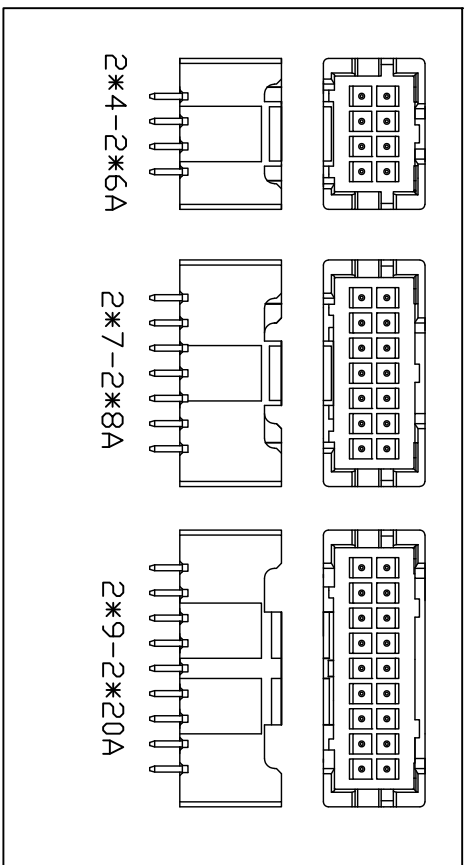
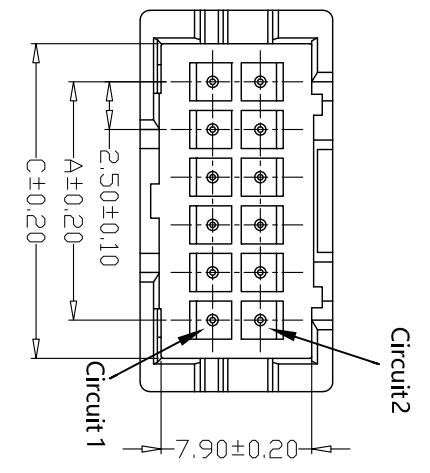

PCB LAYOUT

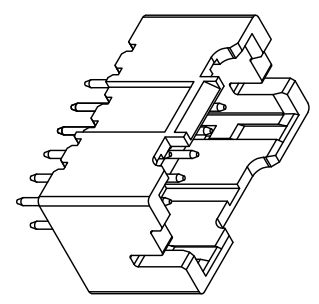
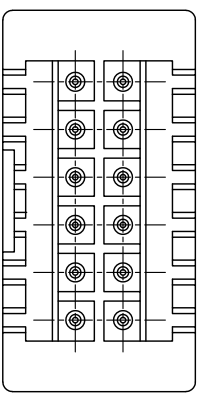
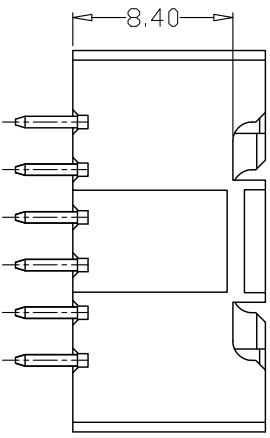
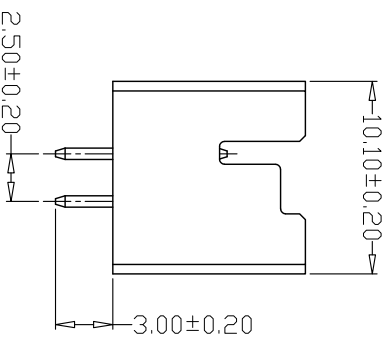
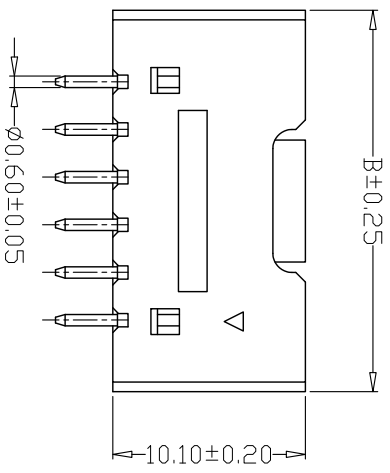

PIN	尺寸 (mm)		
	A	B	C
-2*04A	7.50	15.00	11.50
-2*05A	10.00	17.50	14.00
-2*06A	12.50	20.00	16.50
-2*07A	15.00	22.50	19.00
-2*08A	17.50	25.00	21.50
-2*09A	20.00	27.50	24.00
-2*10A	22.50	30.00	26.50
-2*11A	25.00	32.50	29.00
-2*12A	27.50	35.00	31.50
-2*13A	30.00	37.50	34.00
-2*14A	32.50	40.00	36.50
-2*15A	35.00	42.50	39.00
-2*16A	37.50	45.00	41.50
-2*17A	40.00	47.50	44.00
-2*18A	42.50	50.00	46.50
-2*19A	45.00	52.50	49.00
-2*20A	47.50	55.00	51.50

SPECIFICATIONS

- 1、Current Rating: 3A AC, DC
- 2、Voltage Rating: 250V AC, DC
- 3、Temperature Range: -25°C~+85°C
- 4、Contact Resistance: 20mΩ Max
- 5、Insulation Resistance: 1000MΩ Min
- 6、Withstanding Voltage: 1000V AC/minute
- 7、Material: Wafer PA46, UL94V-0
PIN Brass Tin-plated

GENERAL TOLERANCE		制图 Mapping	
X±0.25	X°±2°	2022.09.16	张迎春
X±0.25	X°±1°	审核 Audit	钱岳生
.XX±0.15	.XX°±0.5°	批准 Approved	张名
.XXX±0.10	.XXX°±0.5°	单位 Units	2022.09.17
		mm	比例 SCALE

料号 PART NO.		客户料号 CUST. NO.	
A25005-2*na	版本 REV.		版本 REV.
品名 TITLE	页次 SHEET	品名 TITLE	页次 SHEET
XA双排直针	1/1	WAFFER DIP TYPE	

乐清市宏一电子有限公司
YueQing HongYi Electronics Co., Ltd

REV.	日期	ECN NO.	变更内容	制图
DATE	DATE	DESCRIPTION	DRAWN	

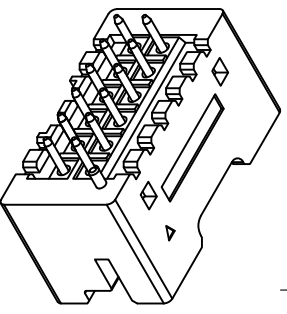
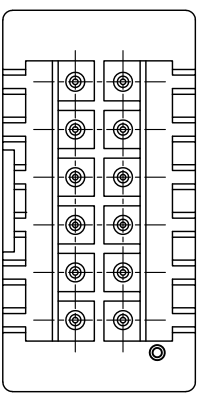
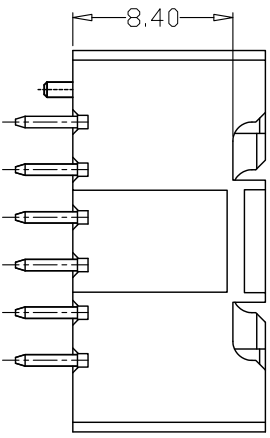
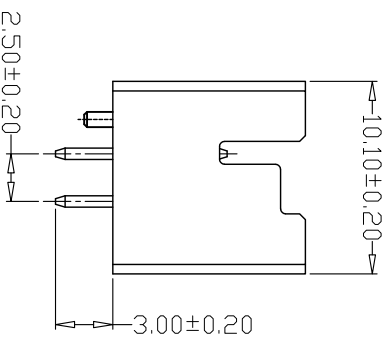
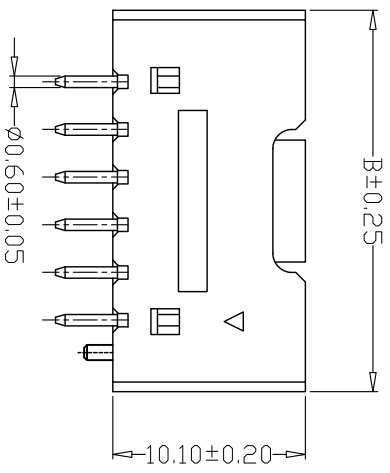
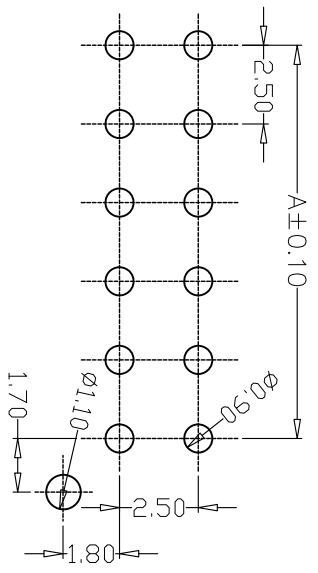
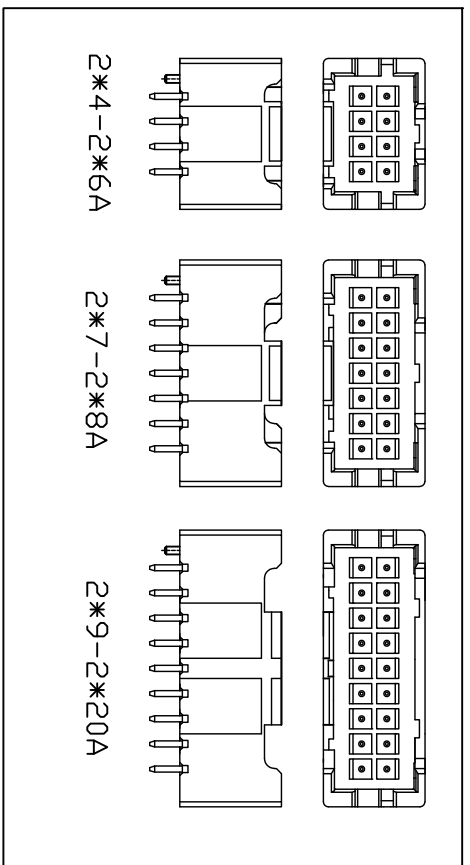
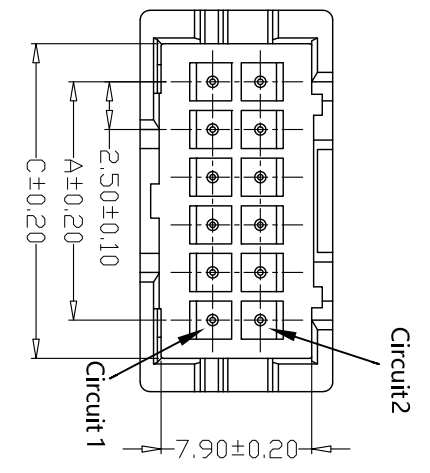

PCB LAYOUT

PIN	尺寸 (mm)		
	A	B	C
-2*04A1	7.50	15.00	11.50
-2*05A1	10.00	17.50	14.00
-2*06A1	12.50	20.00	16.50
-2*07A1	15.00	22.50	19.00
-2*08A1	17.50	25.00	21.50
-2*09A1	20.00	27.50	24.00
-2*10A1	22.50	30.00	26.50
-2*11A1	25.00	32.50	29.00
-2*12A1	27.50	35.00	31.50
-2*13A1	30.00	37.50	34.00
-2*14A1	32.50	40.00	36.50
-2*15A1	35.00	42.50	39.00
-2*16A1	37.50	45.00	41.50
-2*17A1	40.00	47.50	44.00
-2*18A1	42.50	50.00	46.50
-2*19A1	45.00	52.50	49.00
-2*20A1	47.50	55.00	51.50

SPECIFICATIONS

- 1、Current Rating: 3A AC, DC
- 2、Voltage Rating: 250V AC, DC
- 3、Temperature Range: -25°C~+85°C
- 4、Contact Resistance: 20mΩ Max
- 5、Insulation Resistance: 1000MΩ Min
- 6、Withstanding Voltage: 1000V AC/minute
- 7、Material: Wafer PA46, UL94V-0
PIN Brass Tin-plated

GENERAL TOLERANCE		制图		张迎春	
X±0.25	X°±2°	Mapping	2022.09.16	张名	2022.09.17
X±0.25	X°±1°	审核	钱岳生	比例	SCALE
.XX±0.15	.XX°±0.5°	Approved	2022.09.16	单位	mm
.XXX±0.10	.XXX°±0.5°	Units		比例	SCALE

料号		品名		客户料号	
PART NO.	A25005-2*NA1	TITLE	XA双排直针带柱	CITL. NO.	
WAFER DIP TYPE		WAFER DIP TYPE			

乐清市宏一电子有限公司
YueQing HongYi Electronics Co., Ltd

版本 REV.	日期 DATE	变更内容 DESCRIPTION	制图 DRAWN

- SPECIFICATIONS**
- 1、Current Rating: 3A AC, DC
 - 2、Voltage Rating: 250V AC, DC
 - 3、Temperature Range: -25°C~+85°C
 - 4、Contact Resistance: 20mΩ Max
 - 5、Insulation Resistance: 1000MΩ Min
 - 6、Withstanding Voltage: 1000V AC/minute
 - 7、Material: Wafer PA66, UL94V-0
PIN Brass Tin-plated

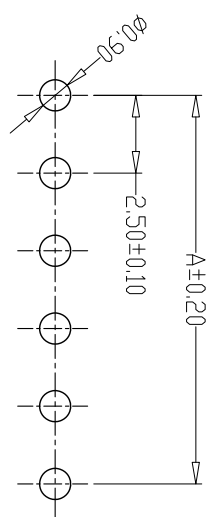
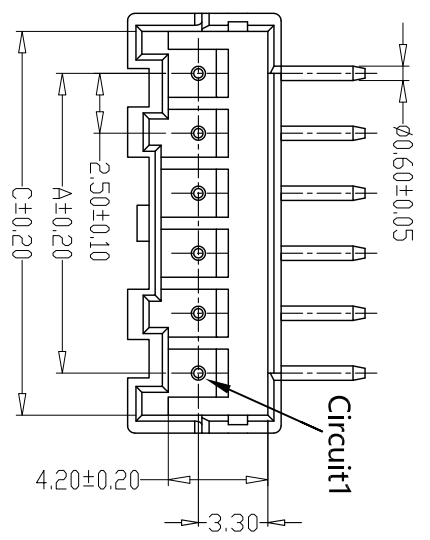

PCB LAYOUT

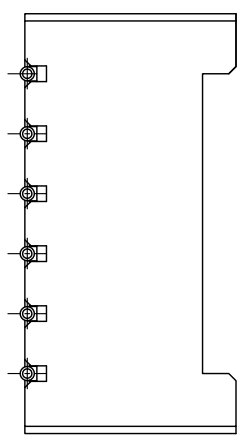
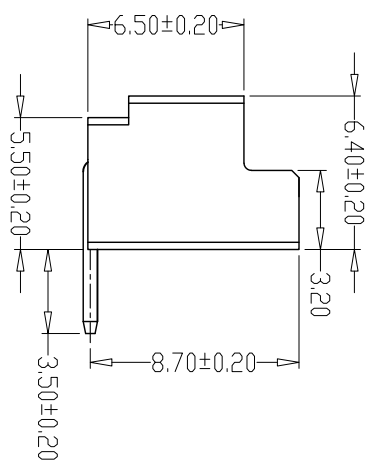
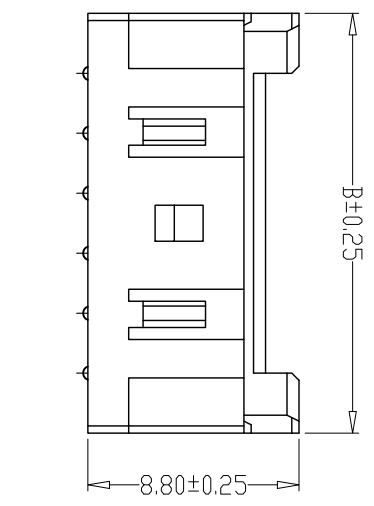

PIN	尺寸 (mm)		
	A	B	C
-02AW	2.50	7.50	6.00
-03AW	5.00	10.00	8.50
-04AW	7.50	12.50	11.00
-05AW	10.00	15.00	13.50
-06AW	12.50	17.50	16.00
-07AW	15.00	20.00	18.50
-08AW	17.50	22.50	21.00
-09AW	20.00	25.00	23.50
-10AW	22.50	27.50	26.00
-11AW	25.00	30.00	28.50
-12AW	27.50	32.50	31.00
-13AW	30.00	35.00	33.50
-14AW	32.50	37.50	36.00
-15AW	35.00	40.00	38.50
-16AW	37.50	42.50	41.00
-17AW	40.00	45.00	43.50
-18AW	42.50	47.50	46.00
-19AW	45.00	50.00	48.50
-20AW	47.50	52.50	51.00

2-5AW

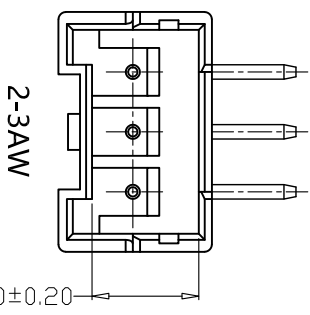
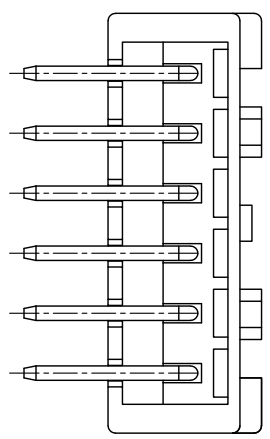
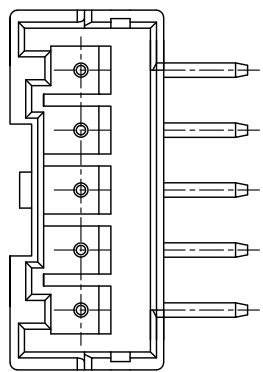

2-3AW

GENERAL TOLERANCE		制图 Mapping		张迎春	
X _{±0.25}	X _{±2°}	审核	钱岳生	2022.09.15	2022.09.15
X _{±0.25}	X _{±1°}	批准	张名	2022.09.16	2022.09.16
X _{±0.15}	X _{±0.5°}	单位	mm	比例	SCALE
XXX±0.10	XXX±0.5°	Units	mm	SCALE	SCALE

料号 PART NO. **A25005-1AW** 版本 REV. **A**

品名 TITLE **XA弯针** 页次 **1/1**

客户料号 WAFER DIP TYPE SHEET

乐清市宏一电子有限公司
YueDing HongYi Electronics Co., Ltd

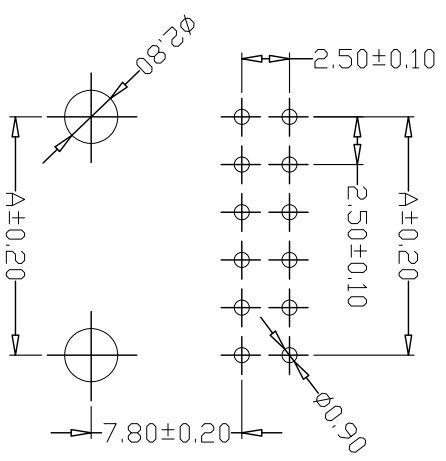
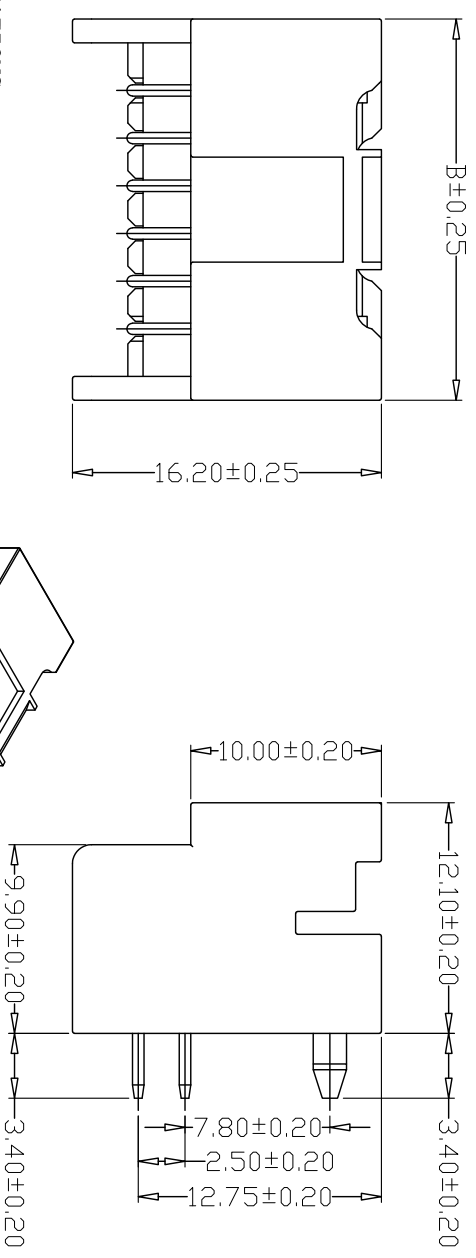
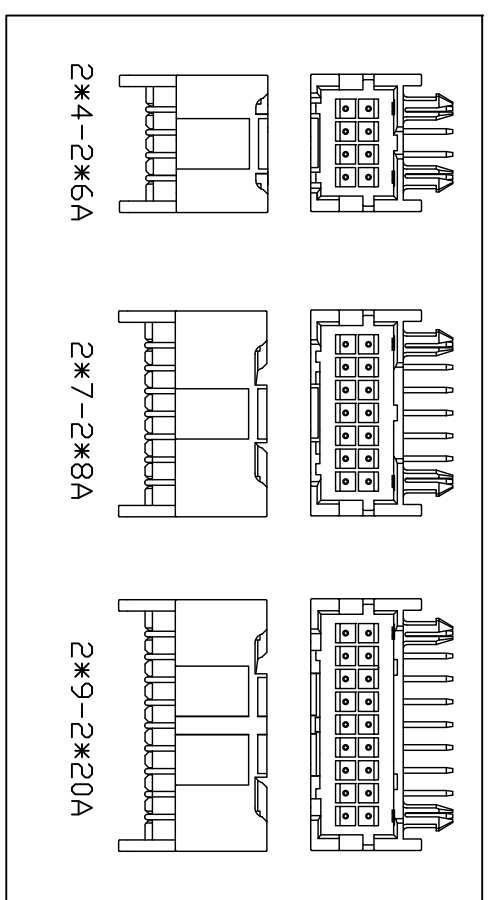
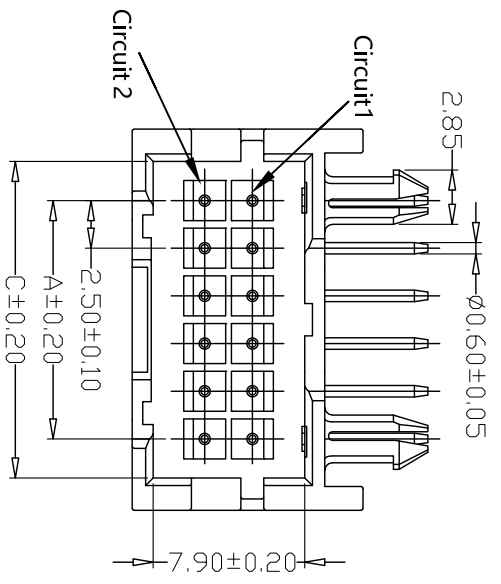

PCB LAYOUT

PIN	尺寸 (mm)		
	A	B	C
-2*04AWD	7.50	15.00	11.50
-2*05AWD	10.00	17.50	14.00
-2*06AWD	12.50	20.00	16.50
-2*07AWD	15.00	22.50	19.00
-2*08AWD	17.50	25.00	21.50
-2*09AWD	20.00	27.50	24.00
-2*10AWD	22.50	30.00	26.50
-2*11AWD	25.00	32.50	29.00
-2*12AWD	27.50	35.00	31.50
-2*13AWD	30.00	37.50	34.00
-2*14AWD	32.50	40.00	36.50
-2*15AWD	35.00	42.50	39.00
-2*16AWD	37.50	45.00	41.50
-2*17AWD	40.00	47.50	44.00
-2*18AWD	42.50	50.00	46.50
-2*19AWD	45.00	52.50	49.00
-2*20AWD	47.50	55.00	51.50

- SPECIFICATIONS
- 1、Current Rating: 3A AC, DC
 - 2、Voltage Rating: 250V AC, DC
 - 3、Temperature Range: -25°C~+85°C
 - 4、Contact Resistance: 20mΩ Max
 - 5、Insulation Resistance: 1000MΩ Min
 - 6、Withstanding Voltage: 1000V AC/minute
 - 7、Material: Wafer PA46, UL94V-0
PIN Brass Tin-plated

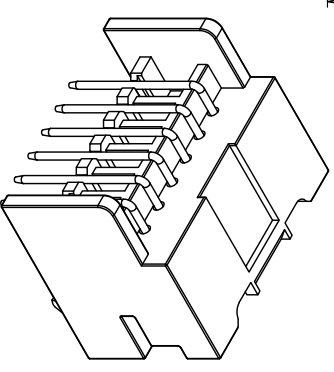

GENERAL TOLERANCE		制图 Mapping	
X±0.25	X°±2°	2022.09.16	张迎春
X±0.25	X°±1°	2022.09.16	钱岳生
XX±0.15	XX°±0.5°	2022.09.17	张名
XXX±0.10	XXX°±0.5°	2022.09.17	张名

料号 PART NO.	品名 TITLE	客户料号 CUST. NO.	版本 REV.
A25005-2*AWD	XA双排定位带柱弯针		A
	WAFFER DIP TYPE		

乐清市宏一电子有限公司
YueDing HongYi Electronics Co., Ltd

版本 REV.	日期 DATE	变更内容 ECN NO.	DESCRIPTION	制图 DRAWN

SPECIFICATIONS

- 1、 Current Rating: 3A AC, DC
- 2、 Voltage Rating: 250V AC, DC
- 3、 Temperature Range: -25°C~+85°C
- 4、 Contact Resistance: 20mΩ Max
- 5、 Insulation Resistance: 1000MΩ Min
- 6、 Withstanding Voltage: 1000V AC/minute
- 7、 Material
Wafer: PA6T UL94V-0
PIN: Brass Tin-plated
Fixed piece: Brass Tin-plated

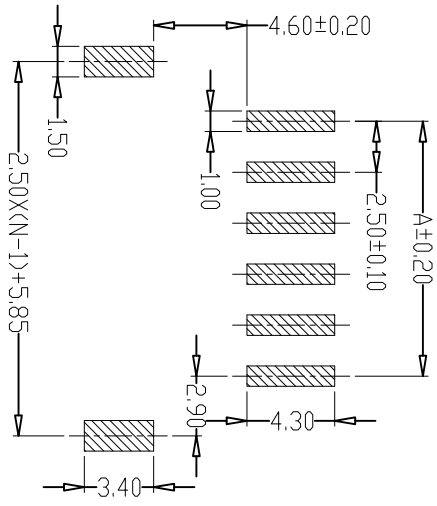
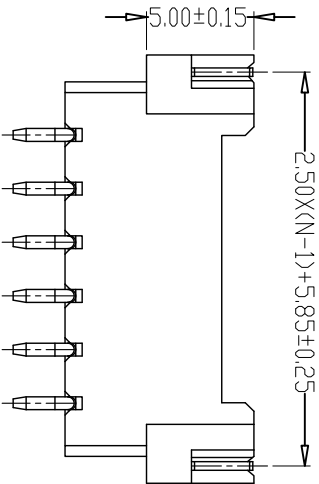
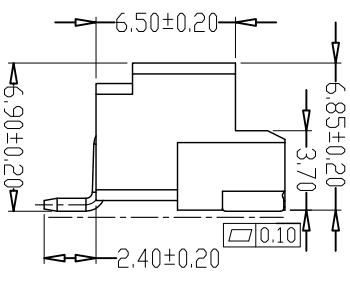
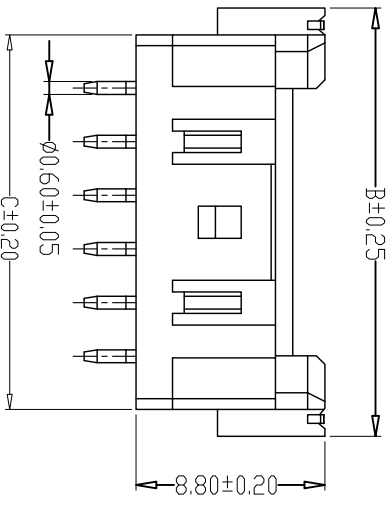
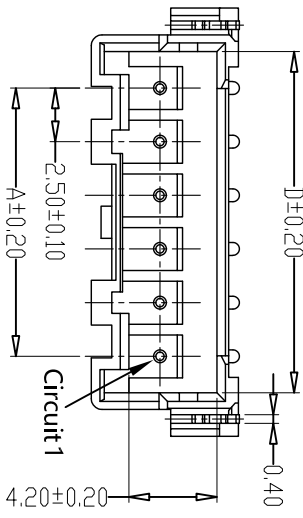
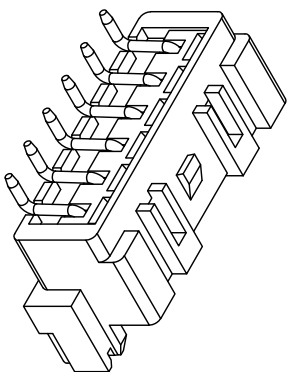

PCB LAYOUT

PIN	尺寸 (mm)			
	A	B	C	D
-02AWB	2.50	10.00	7.50	6.00
-03AWB	5.00	12.50	10.00	8.50
-04AWB	7.50	15.00	12.50	11.00
-05AWB	10.00	17.50	15.00	13.50
-06AWB	12.50	20.00	17.50	16.00
-07AWB	15.00	22.50	20.00	18.50
-08AWB	17.50	25.00	22.50	21.00
-09AWB	20.00	27.50	25.00	23.50
-10AWB	22.50	30.00	27.50	26.00
-11AWB	25.00	32.50	30.00	28.50
-12AWB	27.50	35.00	32.50	31.00
-13AWB	30.00	37.50	35.00	33.50
-14AWB	32.50	40.00	37.50	36.00
-15AWB	35.00	42.50	40.00	38.50

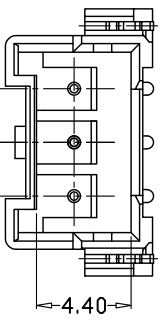
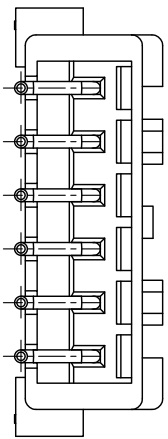
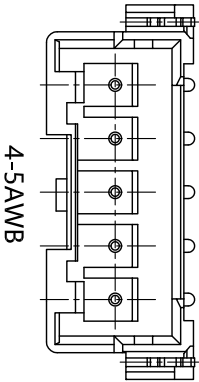

2-3AWB

4-5AWB

GENERAL TOLERANCE		制图 Mapping		张迎春	
X \pm 0.25	X \pm 2°	审核	钱岳生	2022.09.15	
X \pm 0.25	X \pm 1°	核准	张名	2022.09.16	
.XX \pm 0.15	.XX \pm 0.5°	单位	mm	比例	SCALE
.XXX \pm 0.10	.XXX \pm 0.5°	Units			

料号 PART NO. A25005-nAWB
 品名 客户料号 XA 客户料号 WAIVER SMT TYPE
 TITLE
 CTRM. NO.

版本 REV. A
 页次 1/1
 SHEET

乐清市宏一电子有限公司
 YueDing HongYi Electronics Co., Ltd

SPECIFICATIONS

- 1、Current Rating: 3A AC, DC
- 2、Voltage Rating: 250V AC, DC
- 3、Temperature Range: -25°C~+85°C
- 4、Contact Resistance: 20mΩ Max
- 5、Insulation Resistance: 1000MΩ Min
- 6、Withstanding Voltage: 1000V AC/minute
- 7、Material: Wafer PA6T, UL94V-0
PIN Brass Tin-plated
Fixed piece: Brass Tin-plated

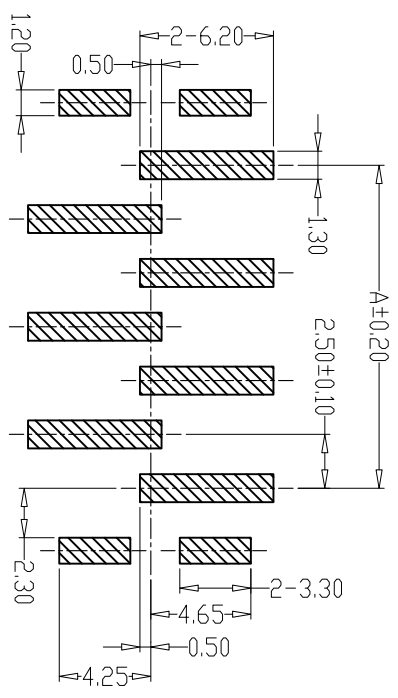
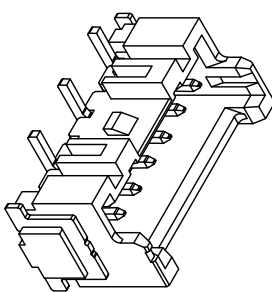
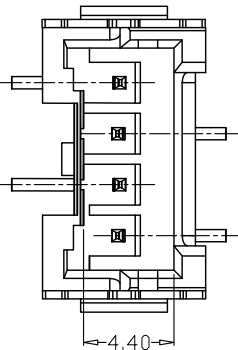
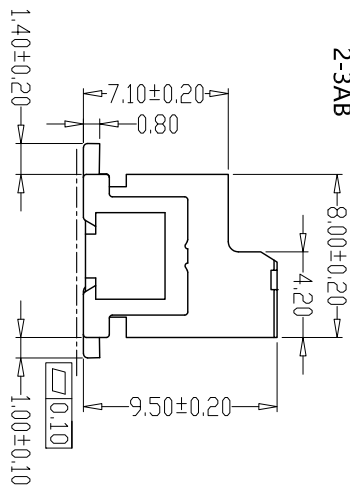
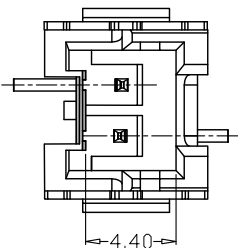
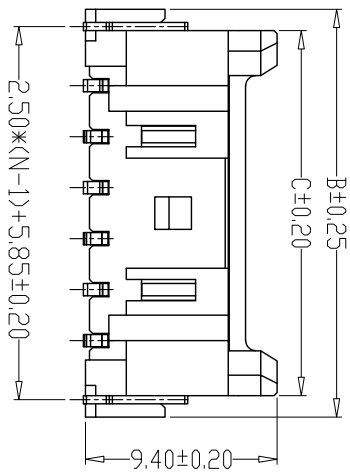
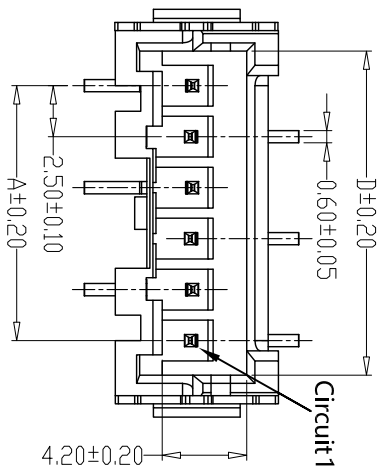

PCB LAYOUT

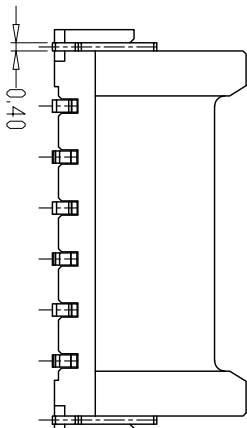
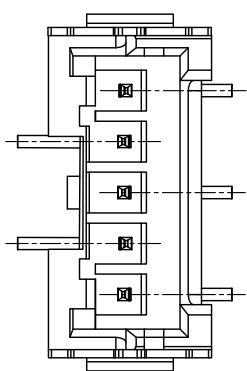
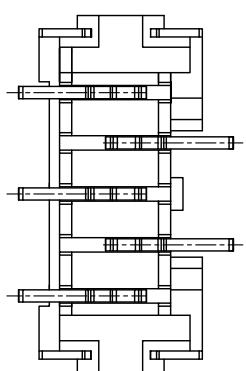
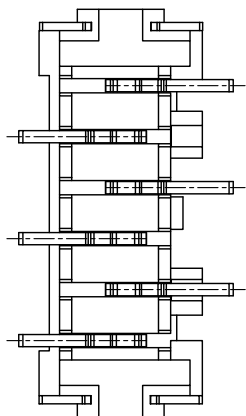

GENERAL TOLERANCE

X \pm 0.25	X \pm 2°	制图 Mapping	张迎春
X \pm 0.25	X \pm 1°	审核 Audit	钱岳生
XX \pm 0.15	XX \pm 0.5°	核准 Approved	张名
XXX \pm 0.10	XXX \pm 0.5°	单位 Units	2022.09.16
		mm	比例 SCALE

PIN	尺寸 (mm)			
	A	B	C	D
-02AB	2.50	10.00	7.90	6.00
-03AB	5.00	12.50	10.40	8.50
-04AB	7.50	15.00	12.90	11.00
-05AB	10.00	17.50	15.40	13.50
-06AB	12.50	20.00	17.90	16.00
-07AB	15.00	22.50	20.40	18.50
-08AB	17.50	25.00	22.90	21.00
-09AB	20.00	27.50	25.40	23.50
-10AB	22.50	30.00	27.90	26.00
-11AB	25.00	32.50	30.40	28.50
-12AB	27.50	35.00	32.90	31.00
-13AB	30.00	37.50	35.40	33.50
-14AB	32.50	40.00	37.90	36.00
-15AB	35.00	42.50	40.40	38.50

料号 PART NO.	A25005-nAB	版本 REV.	A
品名 TITLE	XA立贴 WAFER SMT TYPE	页次 SHEET	1/1
客户料号 CUST. NO.			
张名	2022.09.16		

乐清市宏一电子有限公司
YueDing HongYi Electronics Co., Ltd